

I/B. ①

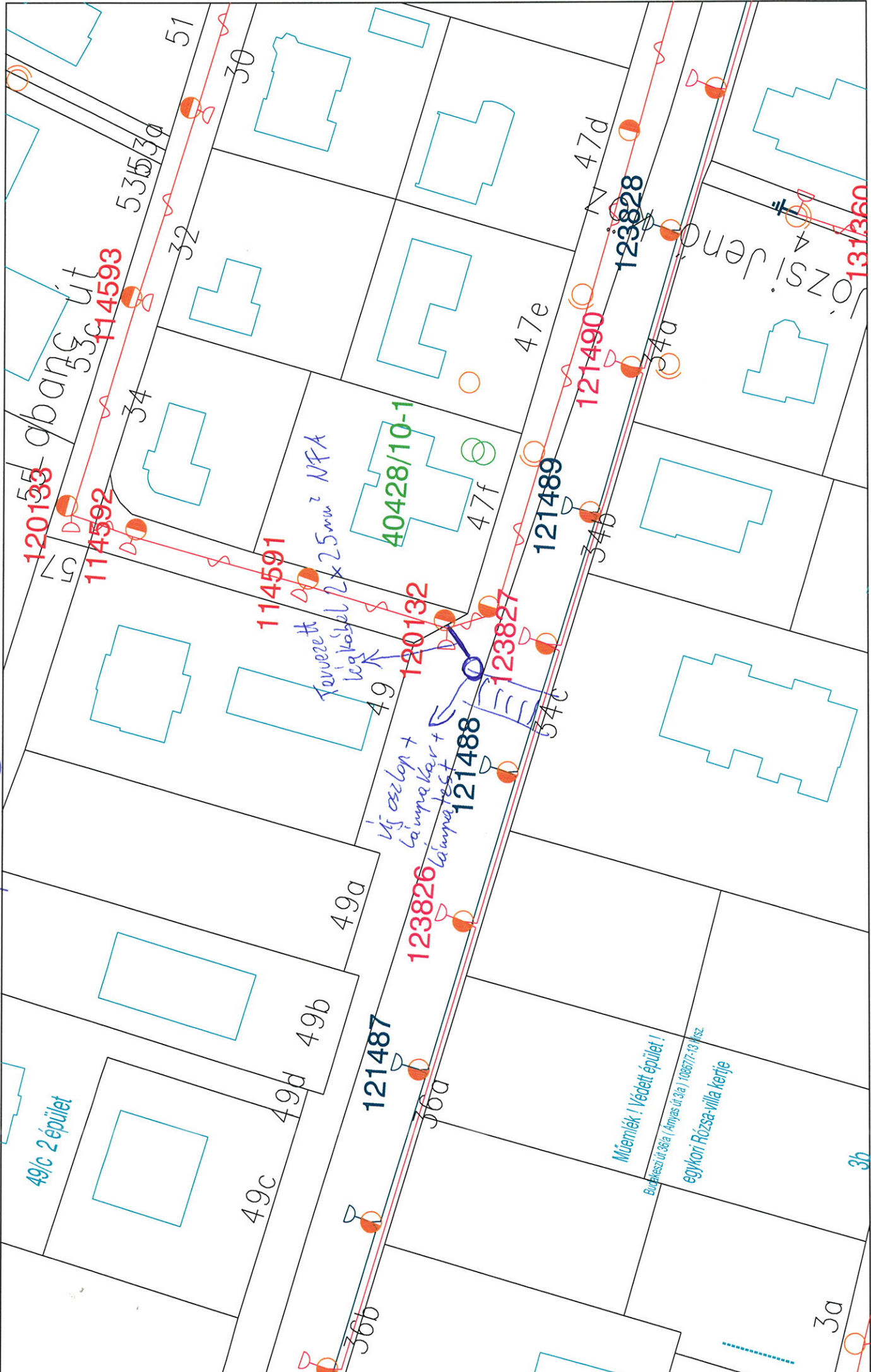

II. Malina-revetési - Szedvényi kereszt. 115 P. Zafu 150W 3oszlop kell. 2018-13

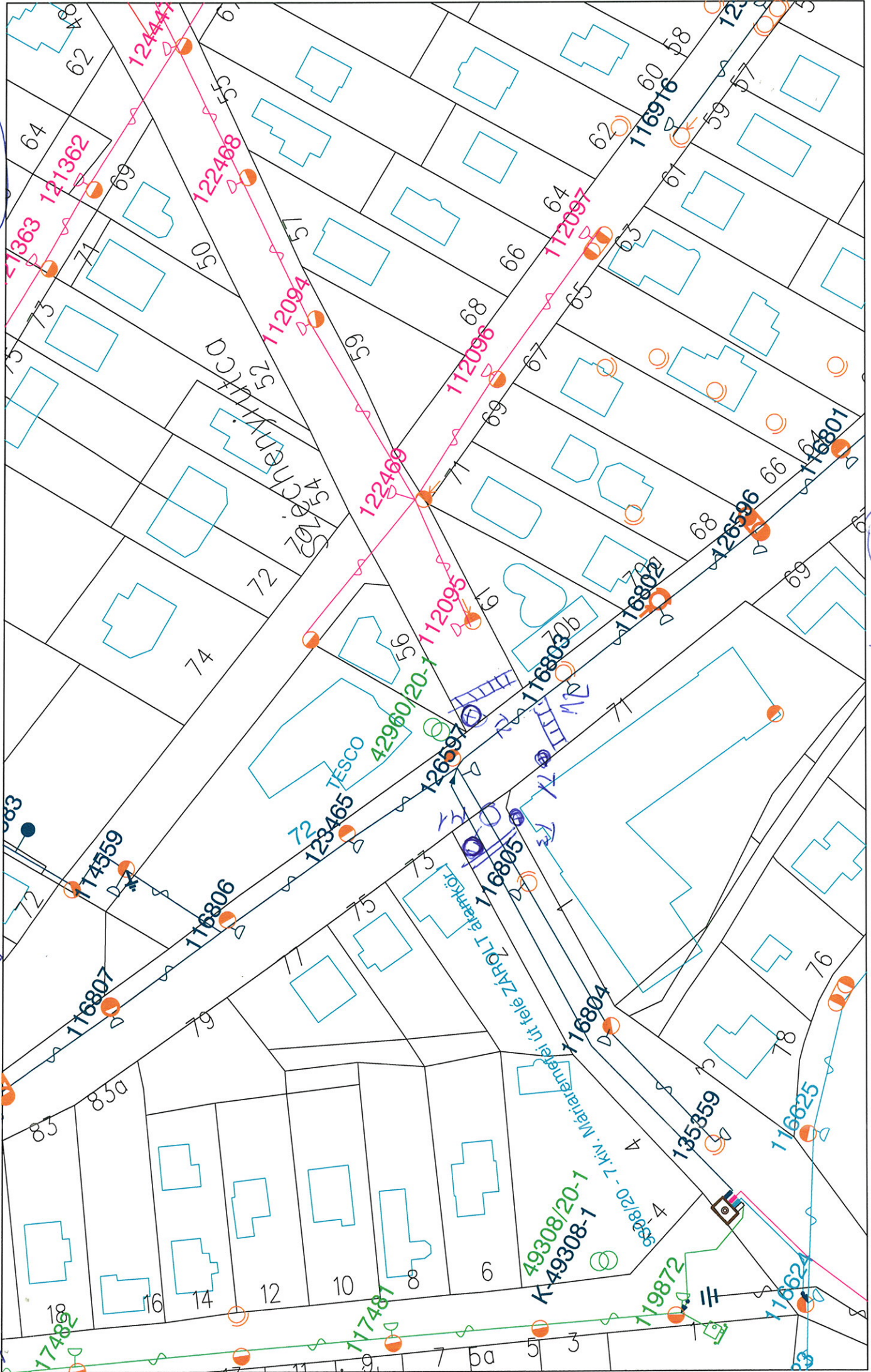

I/B. 2.

I/B. 3.

ud. b.

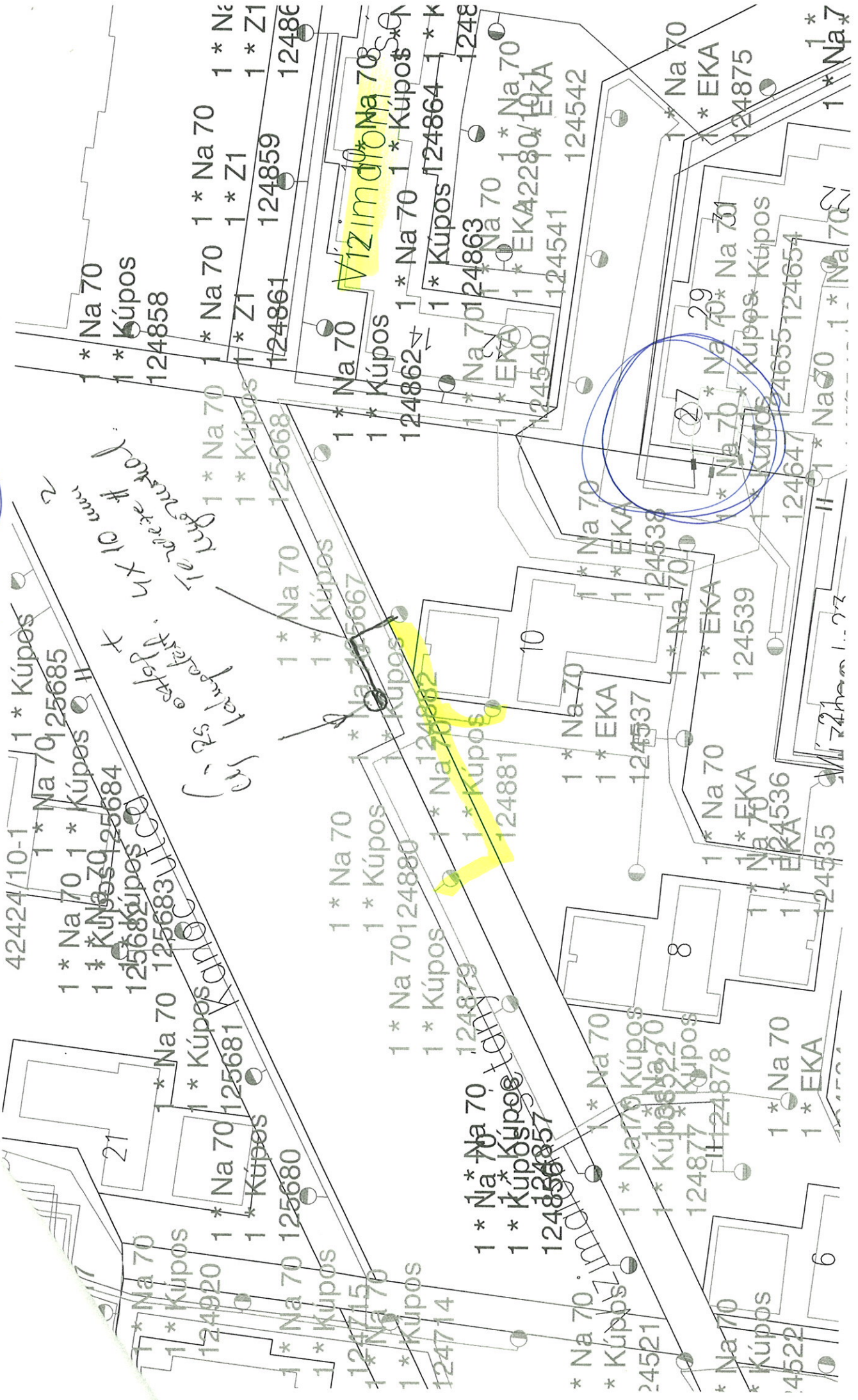

1 * Na 70
 1 * Kúpos
 124858

1 * Na 70 1 * Na 70
 1 * Z1 1 * Z1
 124861 124859 12486

1 * Na 70
 1 * Kúpos
 124862 1 * Na 70 1 * Kúpos *
 1 * Kúpos 124864 1 * K

1 * Na 70 124863
 1 * EKA 1 * Na 70 1 * Na 70
 124540 124541 124542

1 * Na 70
 1 * EKA
 124538

1 * Na 70 29
 1 * Na 70 * Na 70
 1 * Kúpos Kúpos
 124655 124654

1 * Na 70
 1 * Na 70
 124647 124648
 1 * Na 70 1 * Na 70
 124535

42424/10-1
 1 * Na 70 125685
 1 * Kúpos II
 125684
 125683
 1 * Na 70 125681
 1 * Kúpos
 125680

1 * Na 70
 1 * Kúpos
 124879 124879
 1 * Kúpos
 124880 1 * Na 70 124880
 1 * Kúpos 1 * Kúpos
 124881 124881

1 * Na 70
 1 * Kúpos
 124882 124882
 1 * Na 70
 1 * Kúpos
 124883 124883

1 * Na 70
 1 * EKA
 124537 124537
 1 * Na 70
 1 * EKA
 124539 124539

1 * Na 70
 1 * EKA
 124536 124536
 1 * Na 70
 1 * EKA
 124535 124535

1 * Na 70
 1 * EKA
 124534 124534
 1 * Na 70
 1 * EKA
 124533 124533

1 * Na 70
 1 * EKA
 124532 124532
 1 * Na 70
 1 * EKA
 124531 124531

1 * Na 70
 1 * EKA
 124530 124530
 1 * Na 70
 1 * EKA
 124529 124529

1 * Na 70
 1 * Kúpos
 124920 124920
 1 * Na 70
 1 * Kúpos
 124919 124919

1 * Na 70
 1 * Kúpos
 124918 124918
 1 * Na 70
 1 * Kúpos
 124917 124917

1 * Na 70
 1 * Kúpos
 124916 124916
 1 * Na 70
 1 * Kúpos
 124915 124915

1 * Na 70
 1 * Kúpos
 124914 124914
 1 * Na 70
 1 * Kúpos
 124913 124913

1 * Na 70
 1 * Kúpos
 124912 124912
 1 * Na 70
 1 * Kúpos
 124911 124911

1 * Na 70
 1 * Kúpos
 124910 124910
 1 * Na 70
 1 * Kúpos
 124909 124909

1 * Na 70
 1 * Kúpos
 124908 124908
 1 * Na 70
 1 * Kúpos
 124907 124907

1 * Na 70
 1 * Kúpos
 124906 124906
 1 * Na 70
 1 * Kúpos
 124905 124905

10. Péreny: Zsigmond u. 55

1 db 6 m-es oszlop-megfűtő nyomvonalra
1 db körsugárzó lpt

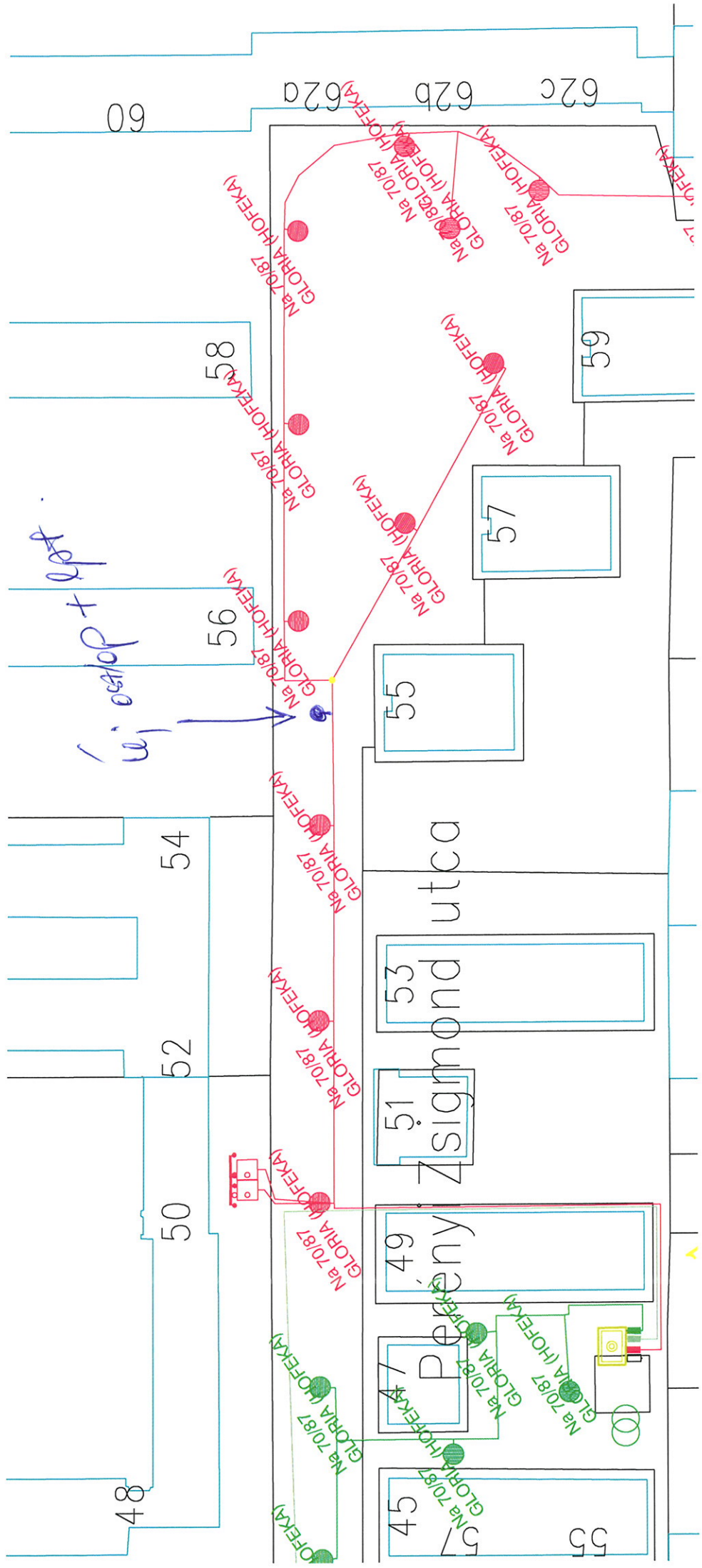

I./B. 4.

92

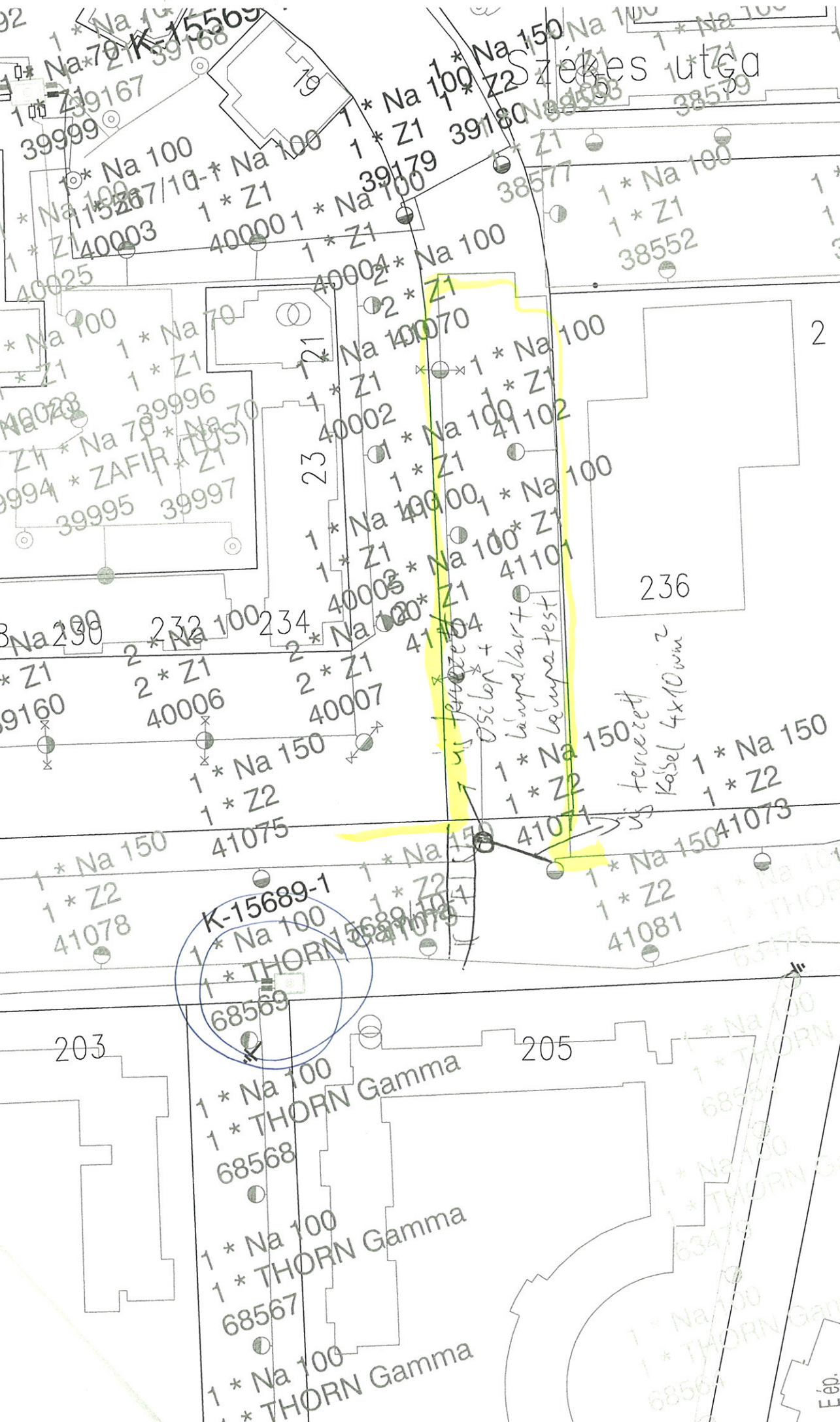

I/B. 5.

u eleje

1 * Na 100
1 * Z1
39167
39999

1 * Na 100
1 * Z1
40003
40025

1 * Na 100
1 * Z1
39996
39994 * ZAFIR (TOS)
39995 39997

1 * Na 100
1 * Z1
40002
40003 * Na 100
40004 * Na 100

1 * Na 100
1 * Z1
40007
41104

1 * Na 150
1 * Z2
41075

1 * Na 100
1 * THORN Gamma
68569

1 * Na 100
1 * THORN Gamma
68568

1 * Na 100
1 * THORN Gamma
68567

1 * Na 100
1 * THORN Gamma

1 * Na 100
1 * Z1
39179

1 * Na 100
1 * Z1
38577

1 * Na 100
1 * Z1
41102

1 * Na 100
1 * Z1
41101

1 * Na 150
1 * Z2
41071

1 * Na 150
1 * Z2
41073

1 * Na 100
1 * THORN Gamma
68569

1 * Na 100
1 * THORN Gamma
68568

1 * Na 100
1 * THORN Gamma
68567

1 * Na 100
1 * THORN Gamma

1 * Na 100
1 * Z1
38579

1 * Na 100
1 * Z1
38552

1 * Na 100
1 * Z1
236

1 * Na 150
1 * Z2
41071

1 * Na 150
1 * Z2
41073

1 * Na 100
1 * THORN Gamma
68569

1 * Na 100
1 * THORN Gamma
68568

1 * Na 100
1 * THORN Gamma
68567

1 * Na 100
1 * THORN Gamma
Eöp.

tervezés
Oscor +
bárpark
bárpark test
tervezés
Közel 4x10 m

Eöp.

XIII. Esztergomi út - Révész utca keresztelődés

I/B. 6

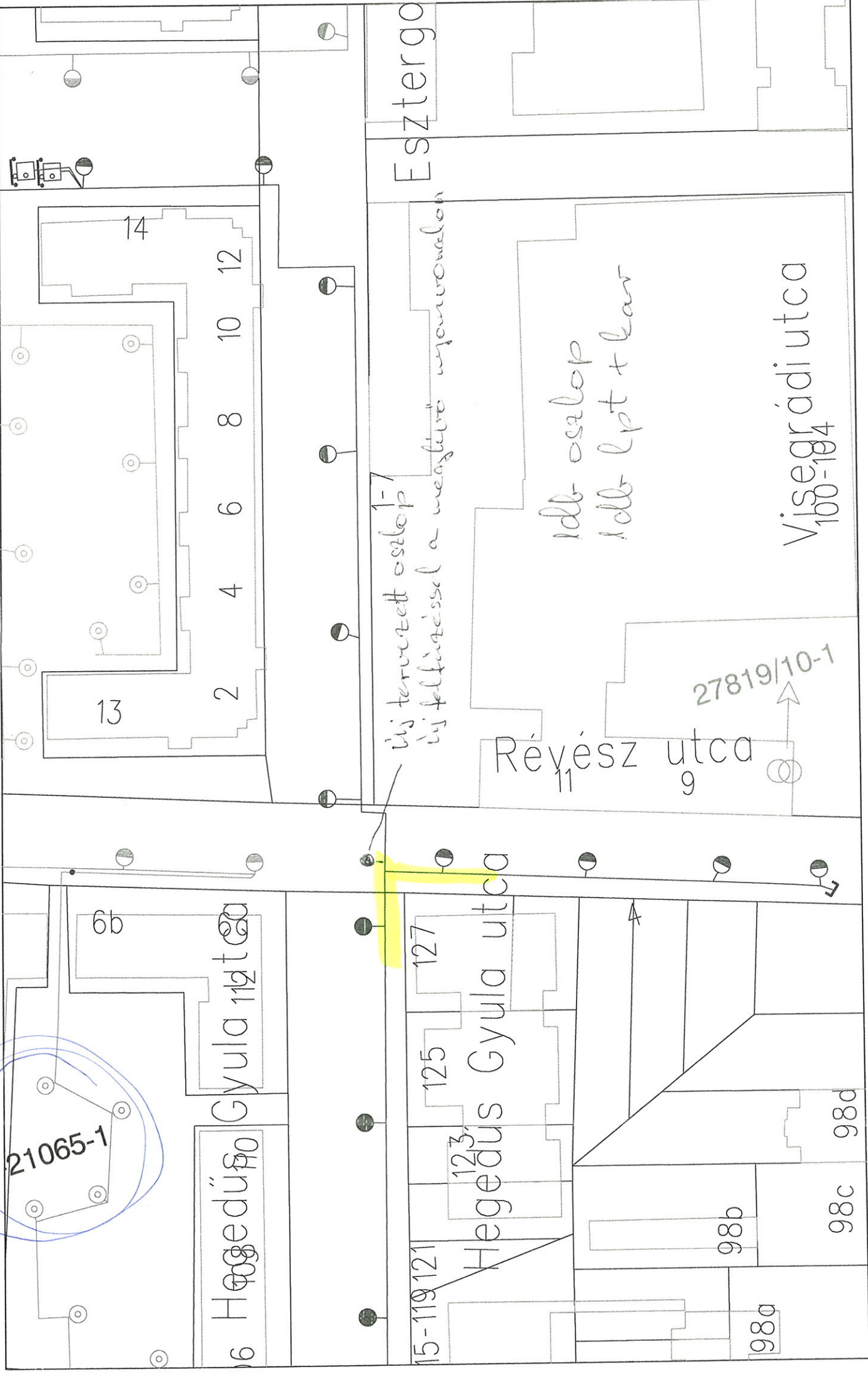

új tervezett oszlop
 új felkötéssel a meglévő információn

1 db oszlop
 1 db lpt + kar

27819/10-1

Visegrádi utca
 100-184

Javaslat: 4db 70W-os legnagyobb felszerelésűe his hátra + 3db B10-400, 3dbb 70W-os R.t., 3dbb his hátra kb. 100m MFA2x2x16g

2018.04.26.



I/B. 7

I/B. 8.

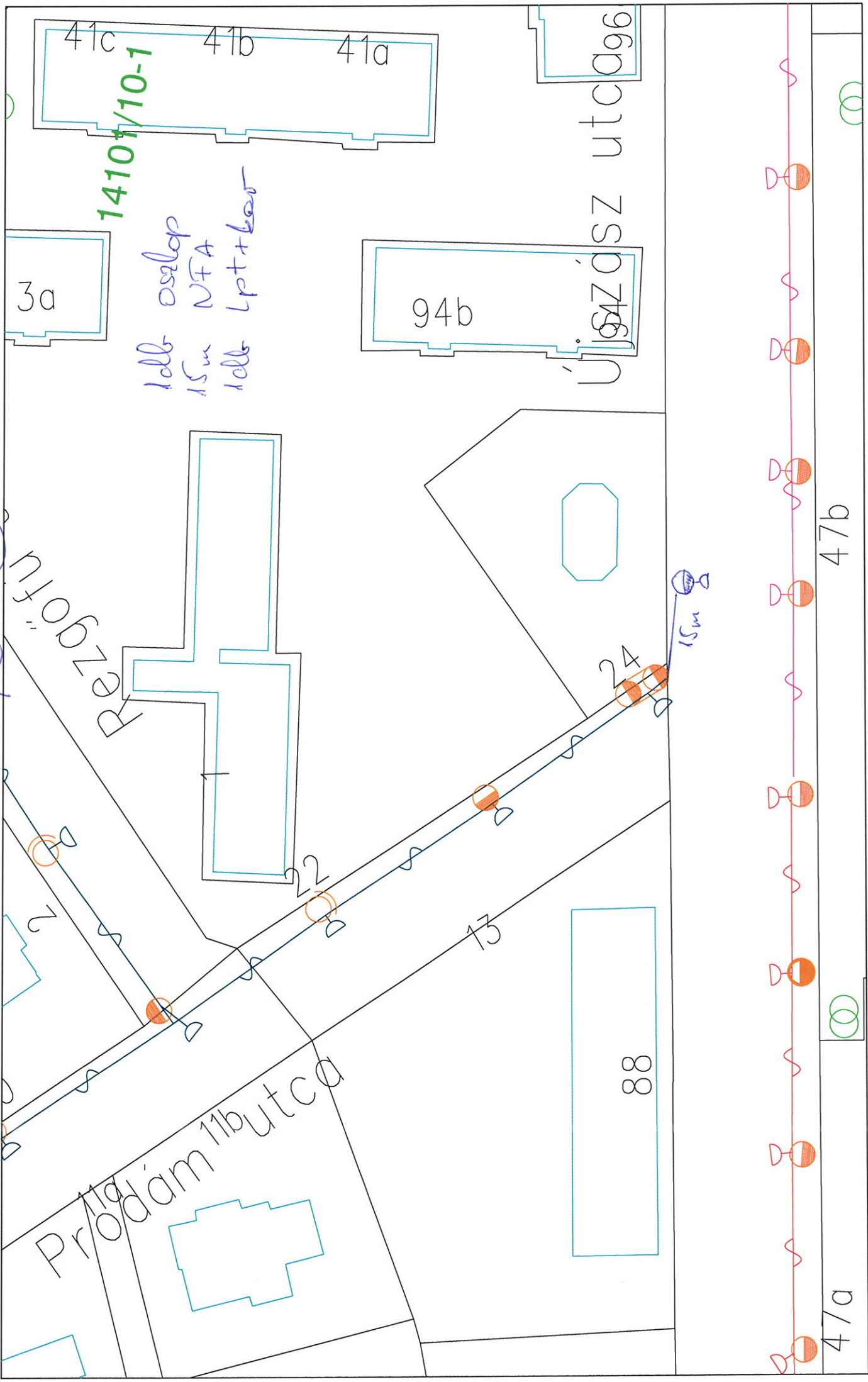

14101/10-1

1 db oszlop
 15m VFA
 1 db Lpt+kar

3a

41c

41b

41a

94b

ÚJ SZÁSZ utc

Rezegetu

Prádám 11butca

24

88

47b

4/a

I./B. 9.

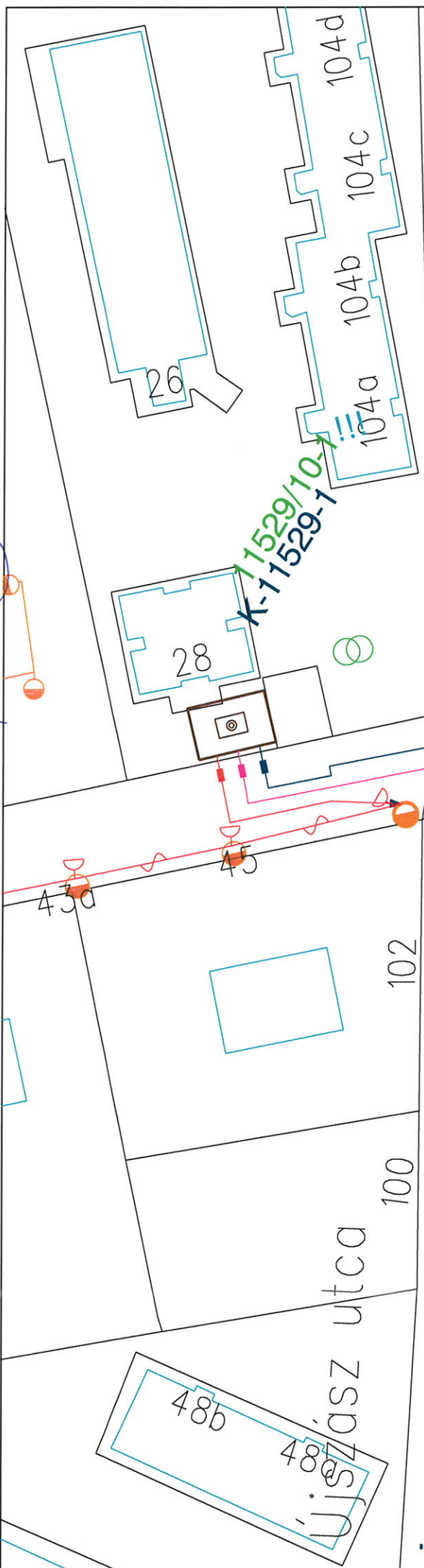

10lg oszlop
18m NFA
10lg CPT+kar

18m

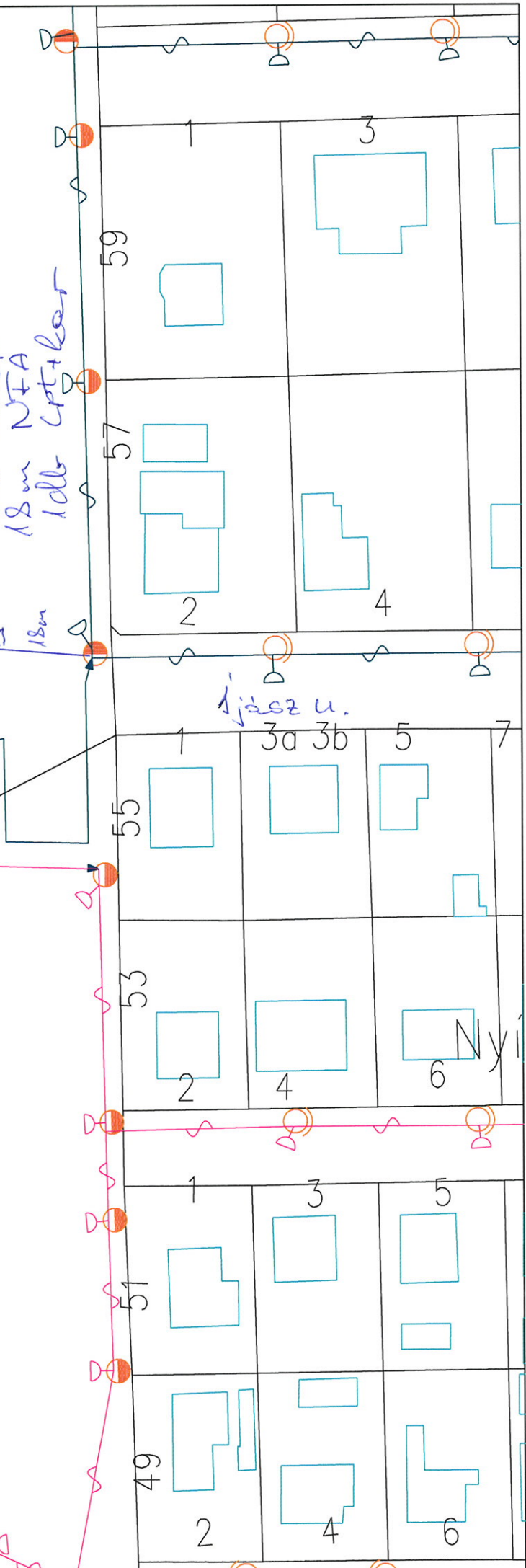

újász u.

Nyíl

I/B. 10.

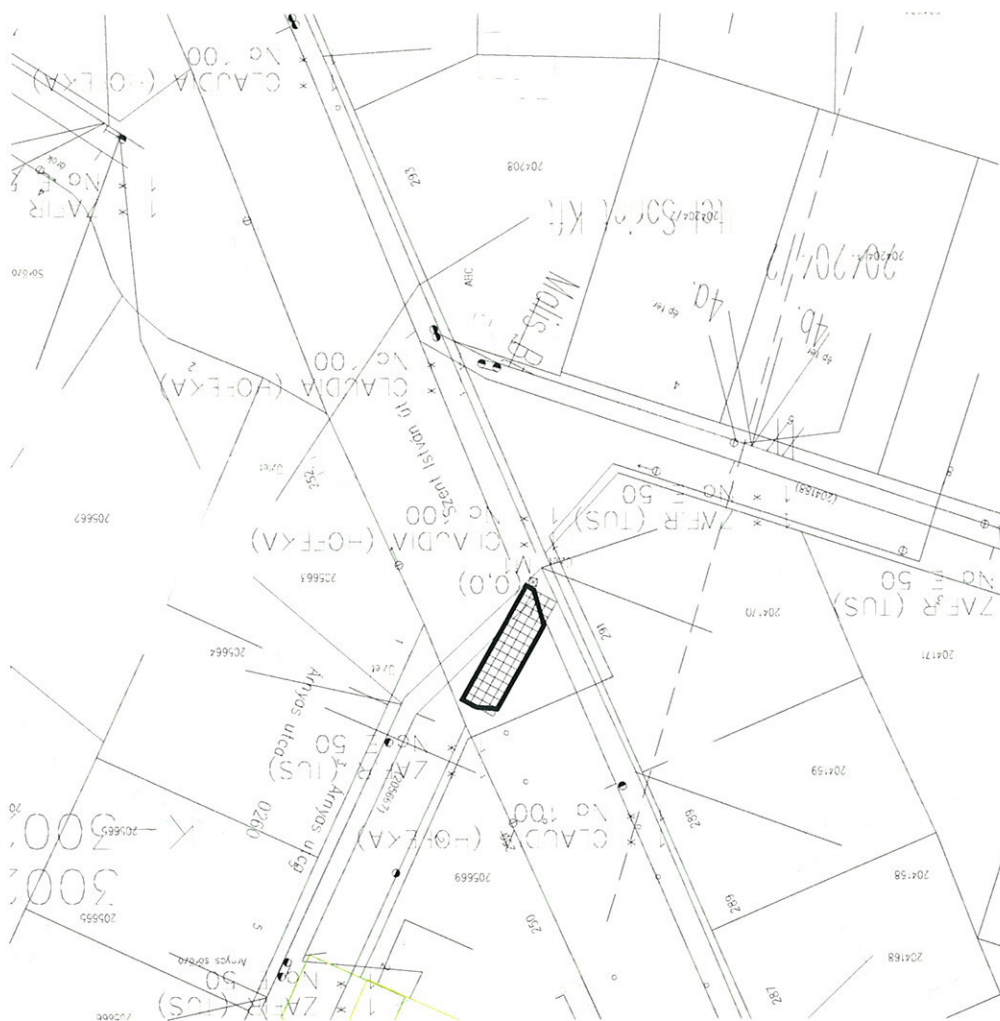

SZASVINYOS MEGULCÁRÍTÁSOK TERVEZÉS SZÜKSÉGES

XXII, JÓKAI M. U. - KÜR U.

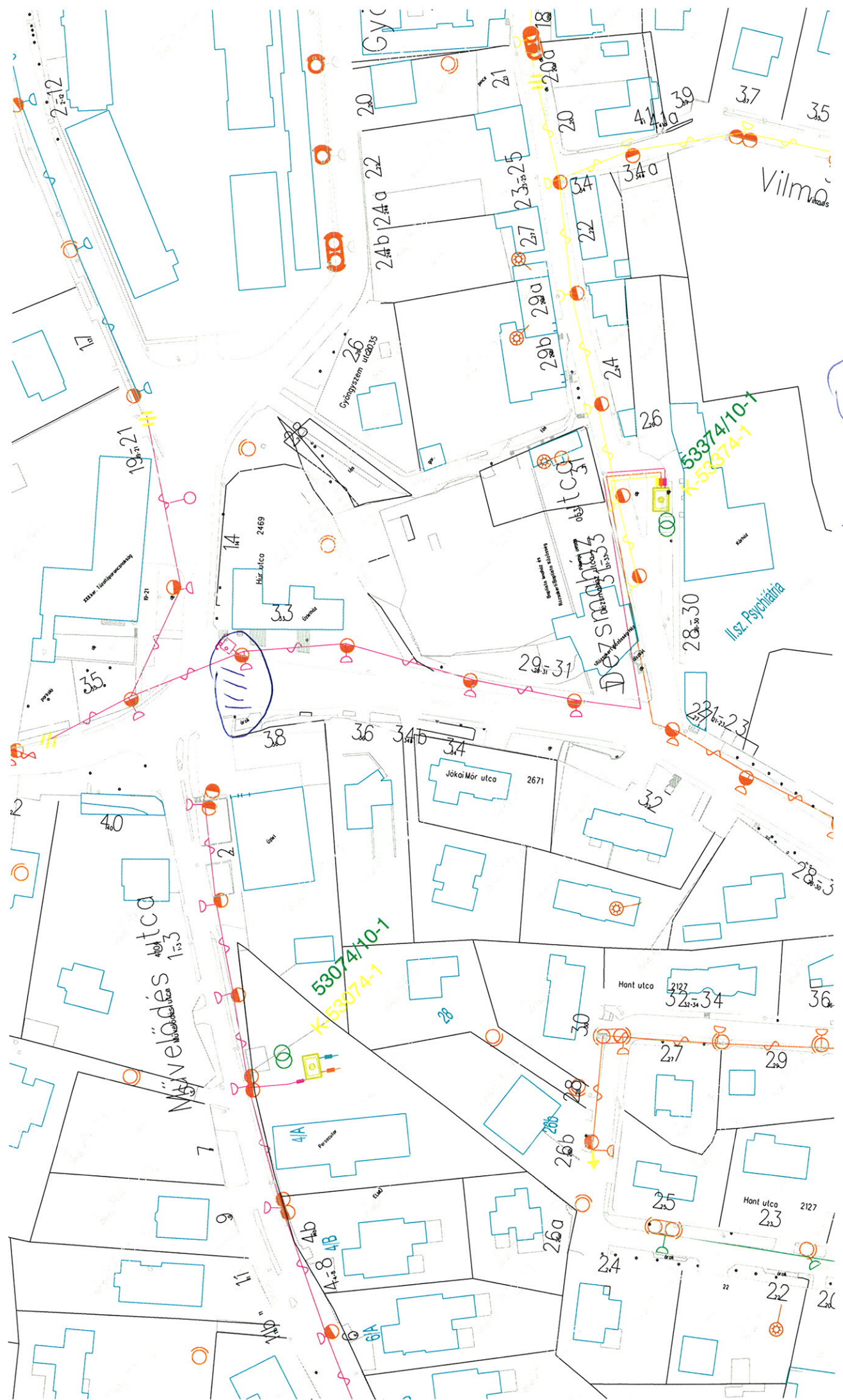

I/B. 11.

xiv. JÖKAI MŰA V. - RIZLING U. 4

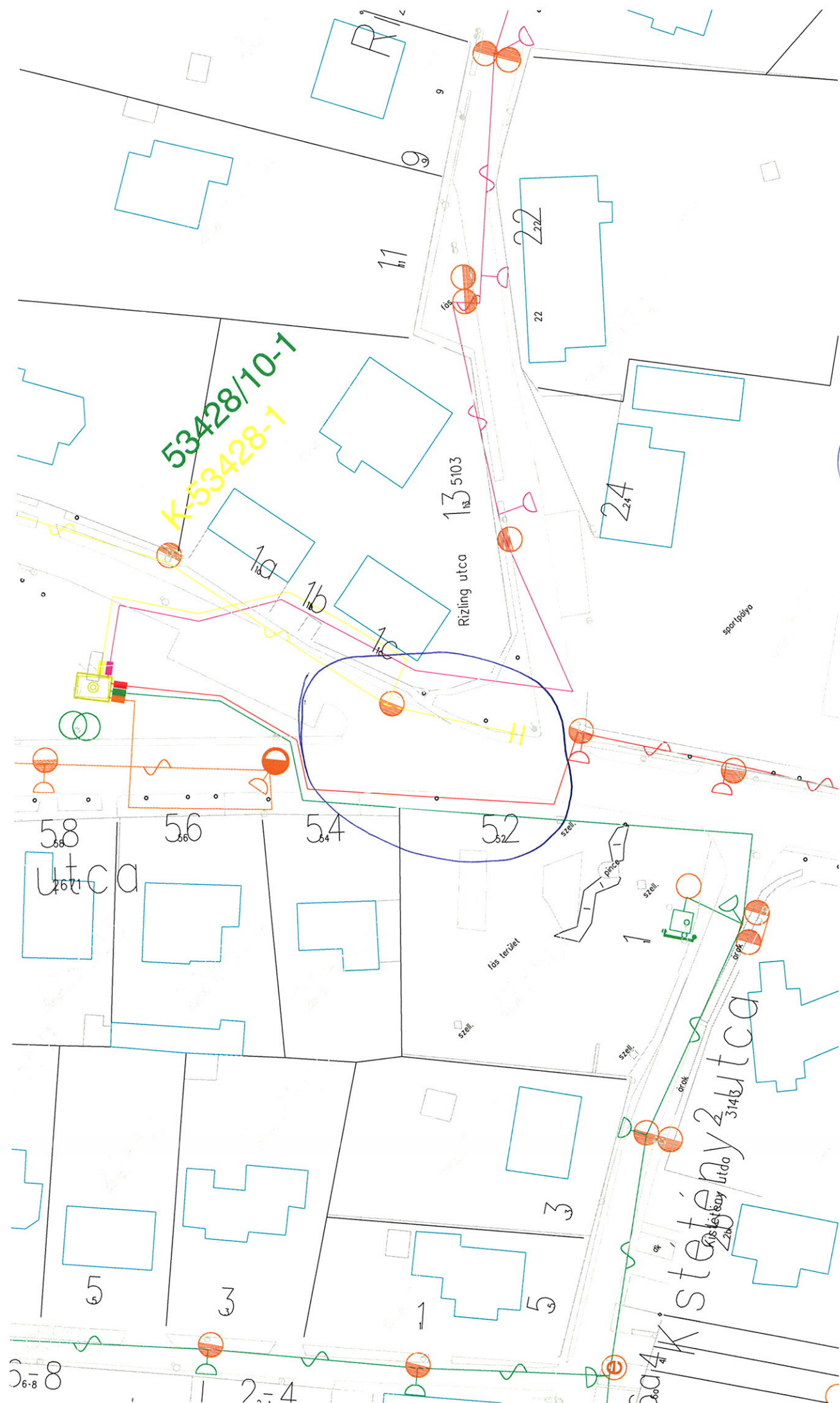

53428/10-1
K-53428-1

13 5103
Rizling utca

spar tölgy

K. Steiner utca
314/3
Kispesti útda
214

I./B. 12

I/B. 13.

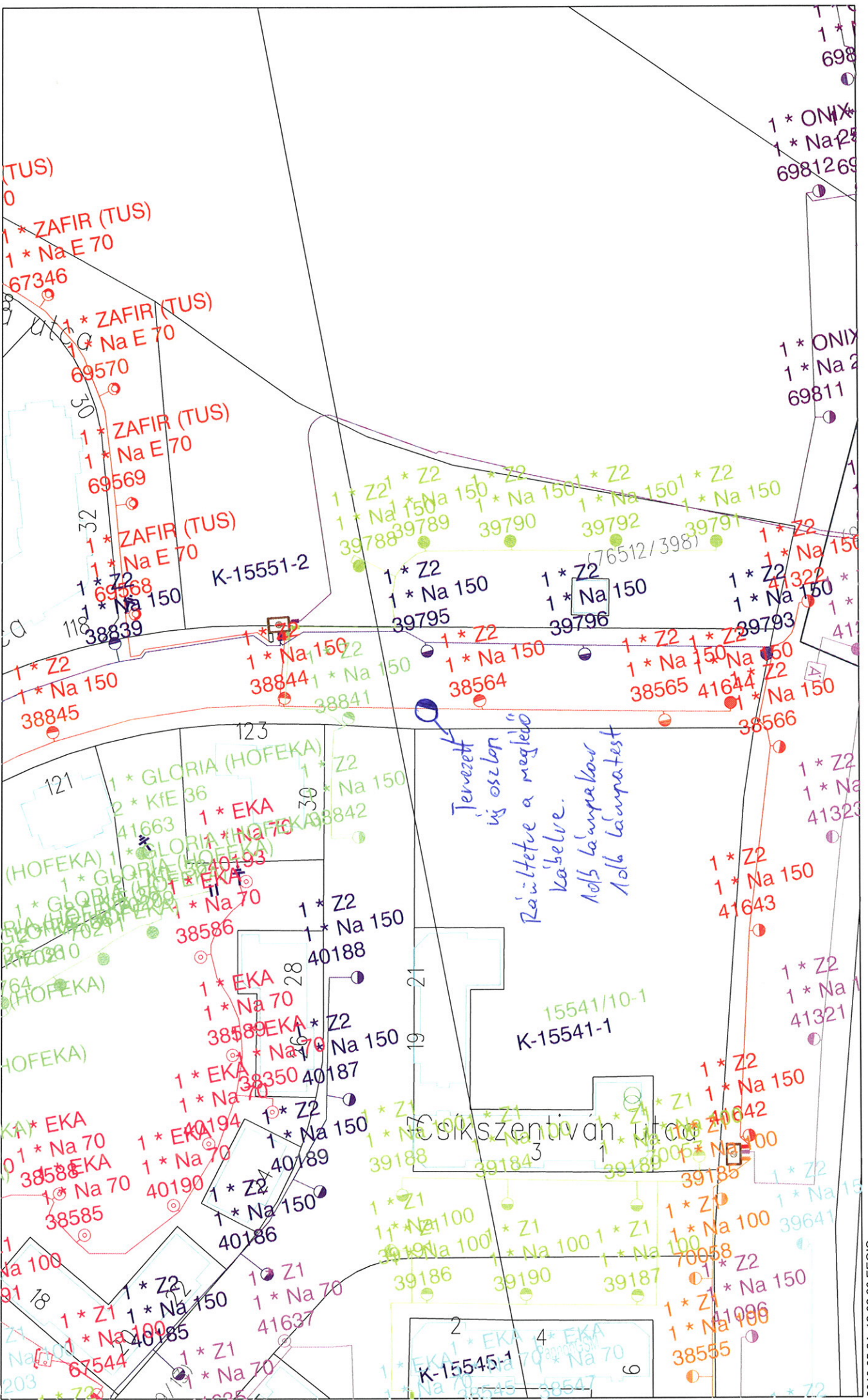

Javaslat: 5db B10-400 szelű + 5db 500 e.t. + 5db hisztor + 10 f. NYV-E 3x2,5 + kb. 14km NFA2x2x16φ + 106 v.p. föld.

2018.05.25.
[Signature]

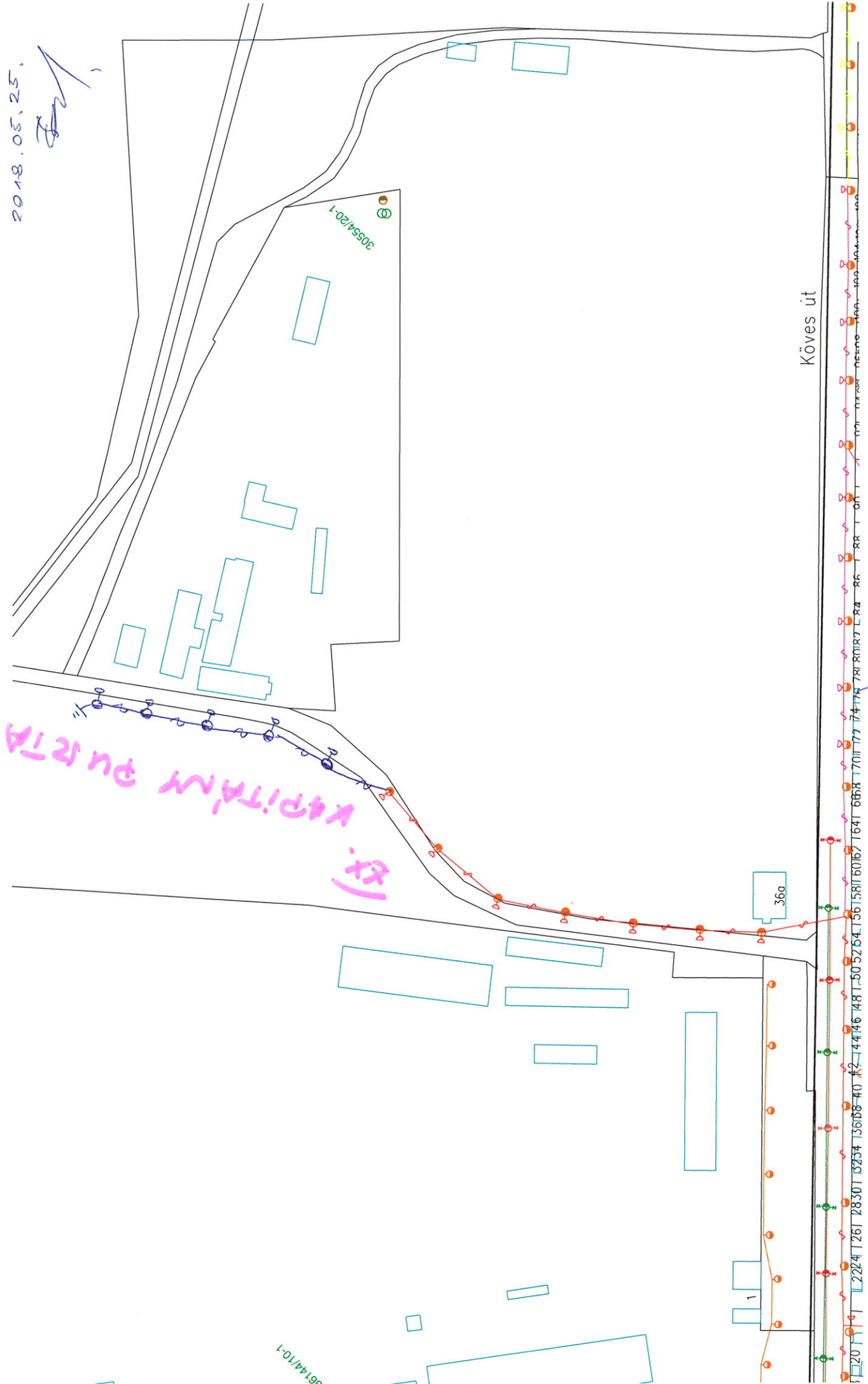

Köves út

I/B. (14.)

Javaslat: kb. 42m MFA2x2x10φ + 1016 betágytatás faoszlop + 206 Las + 206 Las + 170V-os l.t. + 1016 v.p. fől

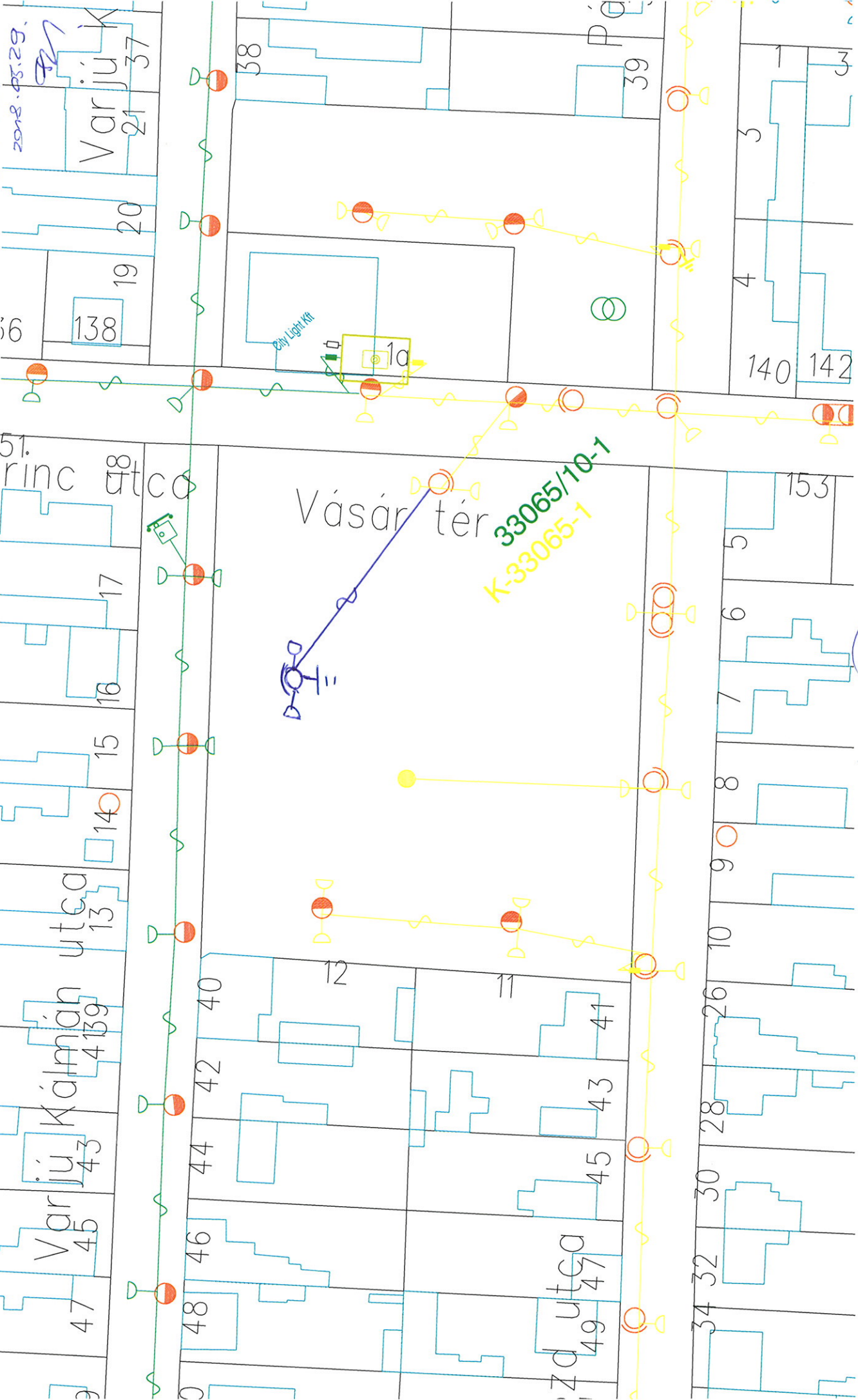

I/B. 15